

SHEET 3 Laying Instruction

Sequence

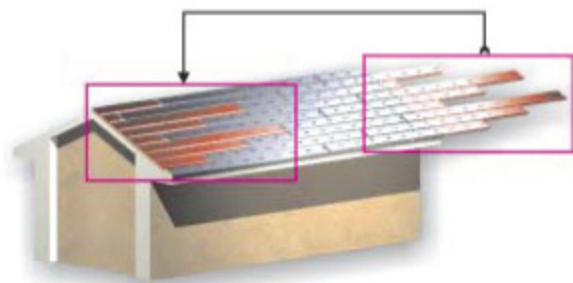

ISOTEC panels are rigid, light and manageable and are easy and fast to lay. Because of their special interlocking shape, they can be laid properly and rapidly even by non-specialized help. Roofing always begins at the eaves and continues upward towards the ridge.

Cutting and fixing panels



The panels can be cut in one step with a disc saw or in two steps using a rip saw with a rigid blade to cut the foam section. Once the panel is cut to the correct size, it can be laid down and attached.

Isotec panels are secured with normal galvanized nails or screws onto wooden structures, or by ordinary screw anchors onto bricks and cement structures.

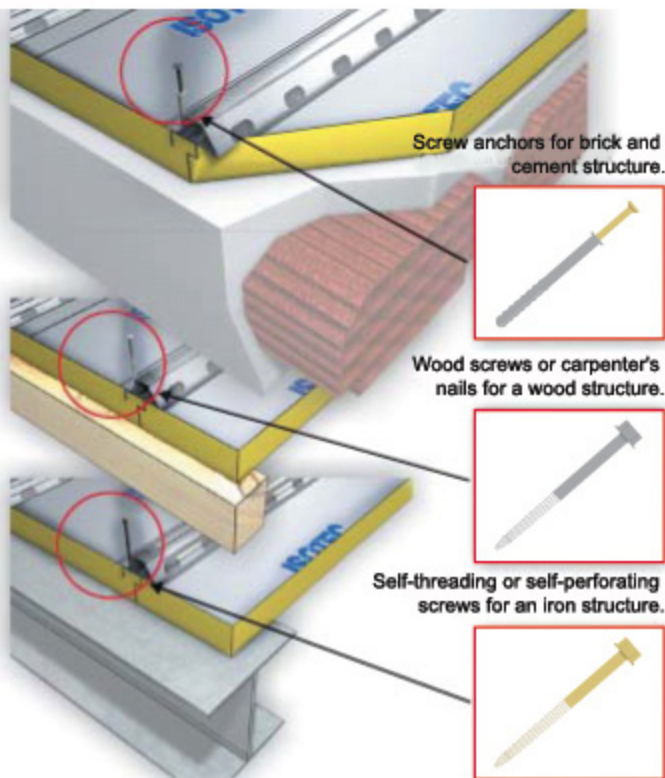

Screw anchors for brick and cement structure.

Wood screws or carpenter's nails for a wood structure.

Self-threading or self-perforating screws for an iron structure.